

SPORTSMEN^{LE}

Travel Trailers



| Travel Trailers | 201RBLE | 210BHLE | 220RDLE | 231BHLE | 231RKLE | 241RLLE | 260BHLE | 261BHLE | 261RLLE | 271BHLE | 282BHLE | 291BHLE | 291RKLE | 301BHLE | 332BHLE |
|------------------------------------|---------|---------|---------|---------|---------|---------|---------|---------|---------|---------|---------|---------|---------|---------|---------|
| UVW (Unloaded Vehicle Weight)* | 4,510 | 4,330 | 4,320 | 4,628 | 4,575 | 5,230 | 4,710 | 5,550 | 5,410 | 5,290 | 5,820 | 6,020 | 6,330 | 6,100 | 7,350 |
| Dry Hitch Weight* | 520 | 500 | 530 | 579 | 502 | 620 | 600 | 600 | 670 | 710 | 820 | 670 | 635 | 630 | 860 |
| Dry Axle Weight* | 3,990 | 3,830 | 3,790 | 4,049 | 4,073 | 4,610 | 4,110 | 4,950 | 4,740 | 4,580 | 5,000 | 5,350 | 5,695 | 5,470 | 6,490 |
| NCC (Net Carrying Capacity) | 1,490 | 1,670 | 1,680 | 1,372 | 1,425 | 1,770 | 1,290 | 1,450 | 1,590 | 1,710 | 1,180 | 1,980 | 1,670 | 1,900 | 1,450 |
| GVWR | 6,000 | 6,000 | 6,000 | 6,000 | 6,000 | 7,000 | 7,000 | 7,000 | 7,000 | 7,000 | 7,000 | 8,000 | 8,000 | 8,000 | 8,800 |
| Interior Height | 78" | 78" | 78" | 78" | 78" | 78" | 78" | 78" | 78" | 78" | 78" | 78" | 78" | 78" | 78" |
| Exterior Height w/ A/C | 10' 10" | 10' 6" | 10' 6" | 10' 6" | 10' 6" | 10' 10" | 10' 8" | 10' 8" | 10' 7" | 10' 7" | 10' 8" | 10' 8" | 10' 8" | 10' 8" | 10' 8" |
| Exterior Width | 96" | 96" | 96" | 96" | 96" | 96" | 96" | 96" | 96" | 96" | 96" | 96" | 96" | 96" | 96" |
| Exterior Length | 24' 6" | 25' | 26' 2" | 27' 5" | 27' 5" | 28' 11" | 30' 6" | 30' 2" | 30' 8" | 31' 3" | 31' 3" | 33' 2" | 33' 2" | 32' 8" | 36' 10" |
| Refrigerator (cu. feet) | 6 | 6 | 6 | 6 | 6 | 6 | 6 | 6 | 6 | 6 | 6 | 6 | 6 | 6 | 6 |
| Water Heater Cap. (gal. G/E w/DSI) | 6 | 6 | 6 | 6 | 6 | 6 | 6 | 6 | 6 | 6 | 6 | 6 | 6 | 6 | 6 |
| Fresh Water Cap. (gal.) | 38 | 38 | 38 | 38 | 38 | 38 | 38 | 38 | 38 | 38 | 38 | 38 | 38 | 38 | 38 |
| Waste Water Cap. (gal.) | 32 | 32 | 32 | 32 | 32 | 32 | 32 | 32 | 32 | 32 | 32 | 32 | 32 | 32 | 32 |
| Gray Water Cap. (gal.) | 32 | 32 | 32 | 32 | 64 | 32 | 32 | 32 | 32 | 32 | 64 | 32 | 32 | 32 | 32 |
| LP Gas Cap. (lbs.) | 40 | 40 | 40 | 40 | 40 | 40 | 40 | 40 | 40 | 40 | 40 | 40 | 40 | 40 | 40 |
| Furnace BTUs (1,000s) | 20 | 20 | 20 | 20 | 30 | 30 | 30 | 30 | 30 | 30 | 30 | 30 | 30 | 30 | 30 |
| Tire Size | 14" | 14" | 14" | 14" | 14" | 14" | 14" | 14" | 14" | 14" | 14" | 15" | 15" | 15" | 15" |
| Awning | 15' | 14' | 16' | 18' | 14' | 17' | 15' | 19' | 15' | 20' | 16' | 18' | 18' | 16' | 19' |

*This weight reflects the rolling average unit weight for each model. Your trailer weight will vary according to optional equipment.

| Toy Haulers | 190THLE | 240THLE | 270THLE |
|------------------------------------|---------|---------|---------|
| UVW (Unloaded Vehicle Weight)* | 4,075 | 4,710 | 5,470 |
| Dry Hitch Weight* | 515 | 750 | 955 |
| Dry Axle Weight* | 3,560 | 3,960 | 4,515 |
| NCC (Net Carrying Capacity) | 2,925 | 2,290 | 3,330 |
| GVWR | 7,000 | 7,000 | 8,800 |
| Interior Height | 78" | 78" | 78" |
| Exterior Height w/ A/C | 10' 8" | 10' 8" | 10' 8" |
| Exterior Width | 96" | 96" | 96" |
| Exterior Length | 21' 7" | 26' 9" | 30' 1" |
| Refrigerator (cu. feet) | 6 | 6 | 6 |
| Water Heater Cap. (gal. G/E w/DSI) | 6 | 6 | 6 |
| Fresh Water Cap. (gal.) | 38 | 38 | 38 |
| Waste Water Cap. (gal.) | 32 | 32 | 32 |
| Gray Water Cap. (gal.) | 32 | 32 | 32 |
| LP Gas Cap. (lbs.) | 40 | 40 | 40 |
| Furnace BTUs (1,000s) | 20 | 20 | 25 |
| Tire Size | 14" | 14" | 14" |
| Awning | 13' | 18' | 20' |

*This weight reflects the rolling average unit weight for each model. Your trailer weight will vary according to optional equipment.

2018 Décor



French Roast

Travel Trailer

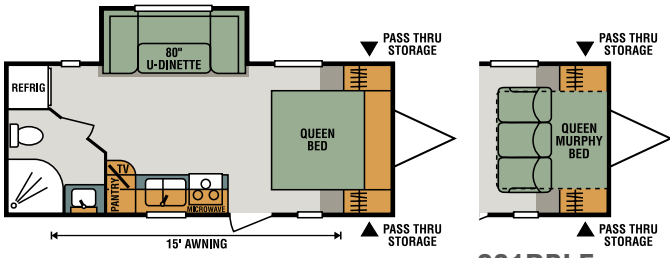

201RBLE

201RBLE
Murphy Bed Option
(patent pending)

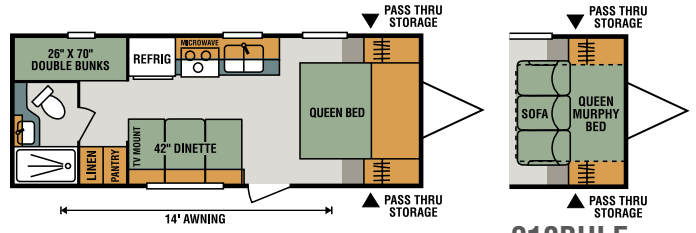

210BHLE

210BHLE
Murphy Bed Option
(patent pending)

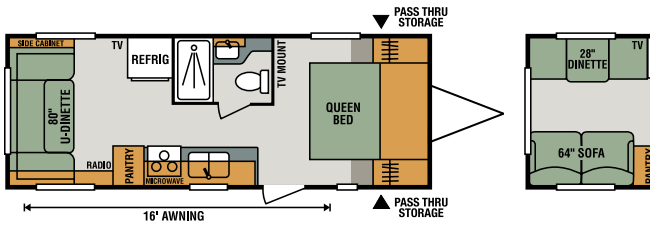

220RDLE

220RDLE
Option

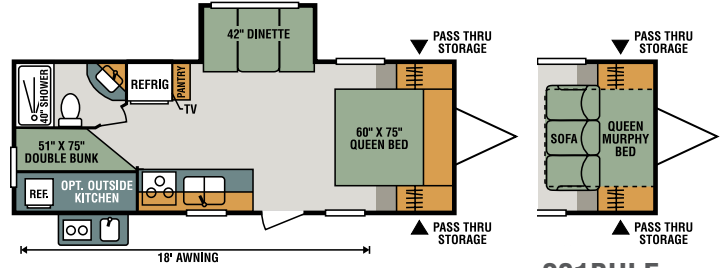

231BHLE

231BHLE
Murphy Bed Option
(patent pending)

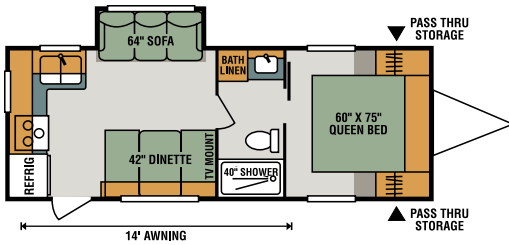

231RKLE

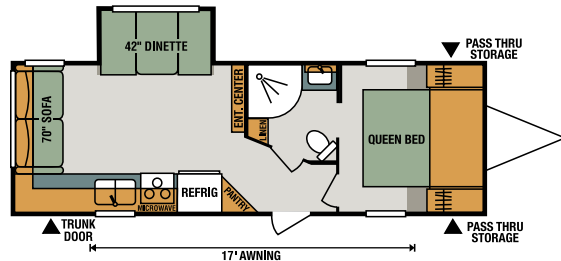

241RLLE

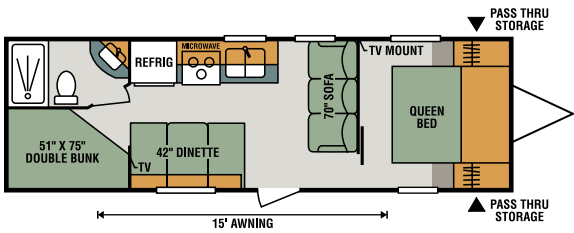

260BHLE

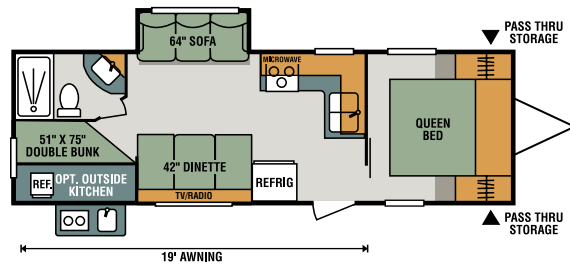

261BHLE **NEW**

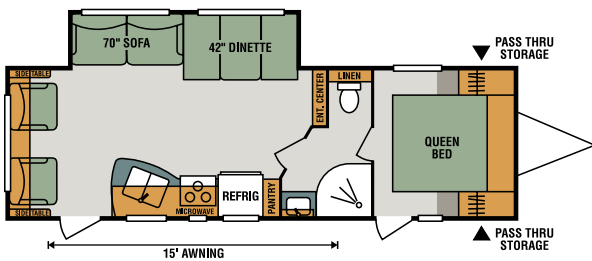

261RLLE **NEW**

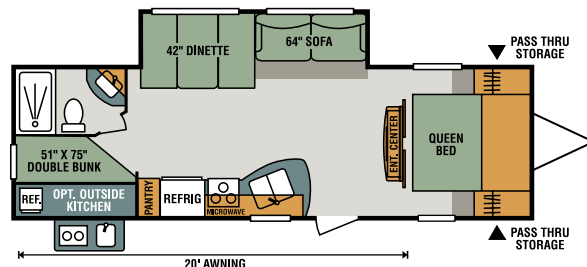

271BHLE

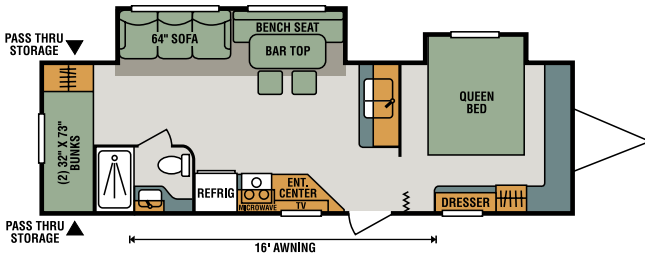

282BHLE

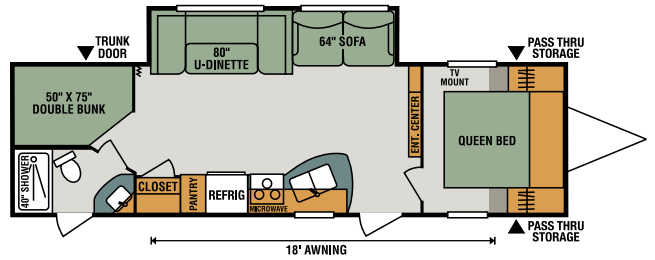

291BHLE

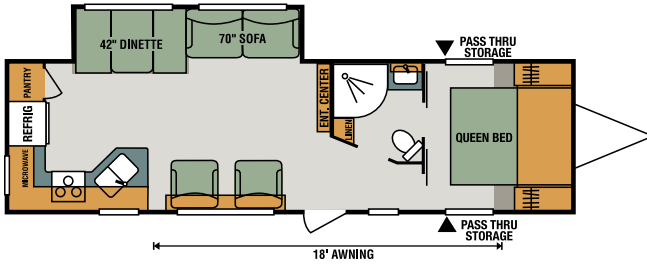

291RKLE **NEW**

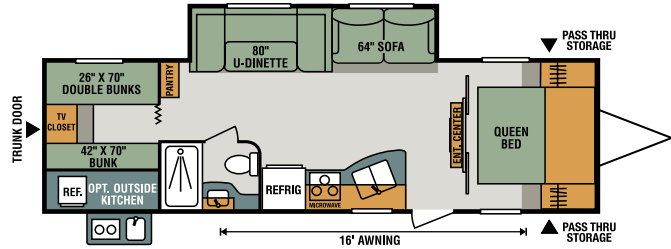

301BHLE

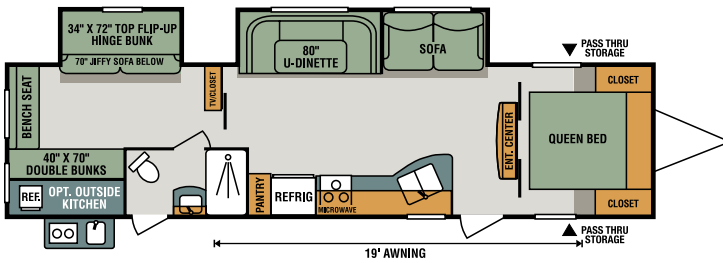

332BHLE **NEW**

Travel Trailer Toy Haulers

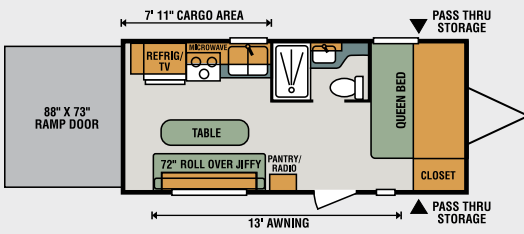

190THLE **NEW**

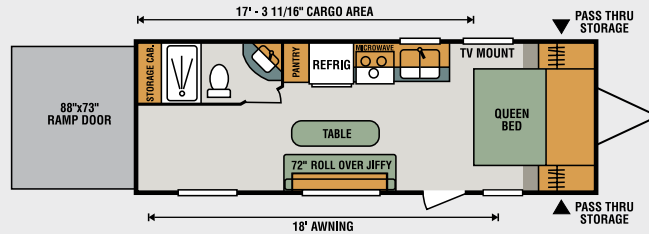

240THLE **NEW**

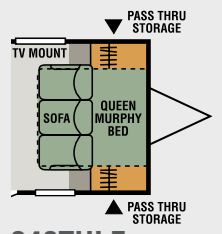

240THLE
Murphy Bed Option
(patent pending)

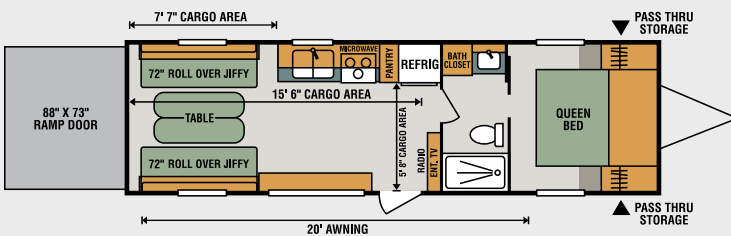

270THLE **NEW**

Standards

- K-Z Exclusive Tough Shield .030 Exterior Metal
- 1-Piece Seamless Roof w/SuperFlex® Roofing Material
- 3/8" Fully Walk-On Roof Decking
- Radius Truss Roof Rafters
- Awning w/Drip Rail & Spouts
- R-7 Insulation
- Radius Entry Door
- Extra-Large Radius Baggage Doors
- Tinted Windows
- Diamond Plate Rock Guard
- Rear Bumper w/Sewer Hose Storage
- (2) 20# LP Bottles
- 30 AMP Service
- Cable Hookup
- Digital TV Antenna w/Booster
- 13,500 BTU A/C
- Water Heater Bypass Kit
- 3-Burner Cooktop
- Range Hood w/12V Light & Exhaust Fan
- Microwave w/Turntable
- Acrylic Sink w/High-Rise Faucet
- Large Overhead Cabinets
- Roller Ball Bearing Drawer Guides
- LED Interior Lighting
- Linoleum Throughout
- Mini Blinds
- Monitor Panel
- Power Vent in Bath
- Reversible Quilted Comforter
- Built-In Medicine Cabinet w/Mirror in Bath
- Shower Surround

Options

- Color-Infused Ivory Exterior Fiberglass
- 15,000 BTU A/C IPO 13,500 BTU A/C
- 50 AMP Service w/2nd A/C Prep

- 2nd A/C (13,500 BTU)
- Oven
- 10 CU FT 12V Residential Refrigerator IPO 6.3 CU FT Gas/Electric Refrigerator (N/A 190TH)
- 39" LED TV (241RL, 271BH, 291BH, 291RK, 301BH, 332BH, 270TH)
- 32" LED TV (231RK, 260BH, 261BH, 282BH)
- 24" LED TV (201RB, 210BH, 220RD, 231BH, 190TH, 240TH)
- Bedroom LED TV w/inside/outside bracket
- F/S Dinette Table w/4 Chairs IPO Dinette
- Wireless Backup Camera System – Observation
- Roof Ladder
- Outside Kitchen (231BH, 261BH, 271BH, 301BH, 332BH)
- Bumper-Mount Grill
- Climate PKG (heated, enclosed & insulated underbelly)
- Flip-Down 71" Storage Rack (N/A on toy haulers)
- Murphy Bed w/Sofa (patent pending) (201RB, 210BH, 231BH, 240TH)
- Rear Dinette & Sofa (220RDLE)
- Sink Cover
- Aluminum Wheels
- Retractable Screen Wall (toy haulers only)
- Motion Security Sensor for Smart Arm Awning
- Wind Sensor for Smart Arm Awning

K-Z Advantage Package

(mandatory option)

Exterior

- 2-Toned Exterior Metal
- Friction-Hinged Entry Door
- Key-Alike Program for Entry & Baggage Doors
- Large Folding Grab Handle
- Power Tongue Jack
- Power Awning w/LED Light Strip
- Exterior Speakers
- Spare Tire & Carrier
- Nitrogen-Filled Tires

- (4) Stabilizer Jacks
- LP Bottle Cover
- Backup Camera Prep
- Solar Prep

Interior

- Jackknife Sofa w/Center Console & Bolster Arms
- 12V Dual USB Port in LR
- Bed Storage System
- Plywood Bed Base w/Gas Struts
- Upper Bunk Windows (select F/Ps)
- Seamless Countertops w/Deep Under-Mount Sink
- Foot-Flush Toilet
- (2) 6 ½" Interior Speakers
- Multi-Media Stereo w/DVD, Bluetooth & NFC Wireless Connectivity
- Blue LED Light Strip above Slideroom (main LR only)

K-Z Convenience Package

(mandatory option)

Exterior

- Smart Arm Awning w/Exterior Controls
- Magnetic Baggage Door Catches
- LED Light & Battery Disconnect in Storage Area
- Omnidirectional HDTV Antenna
- Black Tank Flush
- LED Lights in Exterior Speakers

Interior

- Armstrong® ToughGuard® Linoleum
- 6.3 CU FT Gas/Electric 12V Refrigerator
- Stainless Steel Residential Kitchen Faucet
- Interior Control Switches on OH End Cabinet
- Dark Accent Trim on Corners/Entry Doors
- Electrical Outlet in Bunk Area

