

PALAZZO

MADE TO FIT
YOUR ENTHUSIASM



PALAZZO

 BY THOR MOTOR COACH

SEIZE
THE DAY





33.3 | MOUNTAIN SANDS | OLYMPIC CHERRY



36.2 | ENCORE | VINTAGE MAPLE



36.1 | MOUNTAIN SANDS | VINTAGE MAPLE



WHEN WE SAY *MADE TO FIT*,
WE MEAN IT.

With so many unique models available, Thor Motor Coach motorhomes are priced to fit anyone's budget – from families buying their first motorhome to full-timers looking for a roaming “dream home”. No matter how you choose to spend your time or your money, there's a TMC motorhome that fits your needs.

By building a variety of unique styles, sizes and floor plans, Thor Motor Coach offers motorhomes that feel custom-made – at a truly competitive price.

Welcome to the Palazzo, the motorhome that is *Made to Fit* your enthusiasm.



YOU DESERVE THE FINER THINGS IN LIFE

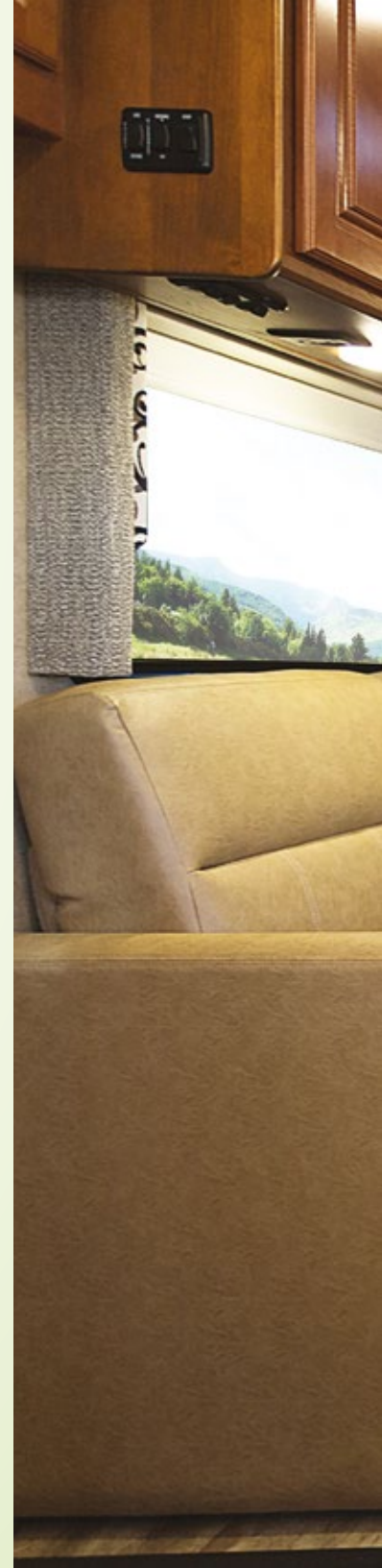
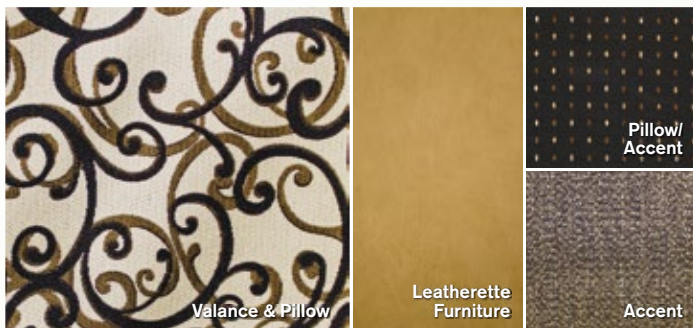





33.3 | SUMMIT PARK | OLYMPIC CHERRY



36.1 | MOUNTAIN SANDS | VINTAGE MAPLE



36.2 | ENCORE | VINTAGE MAPLE



STUNNING BEAUTY & FUNCTIONALITY

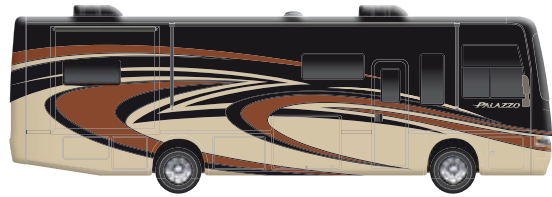

BLACK CANYON FULL-BODY PAINT



BOARDWALK FULL-BODY PAINT



PARK AVENUE FULL-BODY PAINT



RIDGEWOOD FULL-BODY PAINT





A | FULL-BODY PAINT

A striking exterior graphics design provides a jaw-dropping experience. The paint process includes alternating layers of paint and clear coat to provide a silky exterior finish.

B | LARGE PASS-THROUGH STORAGE

Multiple compartments provide plenty of space to take everything along the trip. Most models have a larger pass-through compartment that even includes a sliding tray to increase capacity.

C | FRAMELESS WINDOWS

Sleek, automotive-style frameless windows look great with an added twist of functionality. The windows are hinged to open outward for ventilation, even in rainy weather.

D | POWER PATIO AWNING WITH INTEGRATED LED LIGHTING

Simple push button operation extends and retracts the awning with ease. The integrated LED strip lighting illuminates the camp area, allowing for nighttime use.

E | 3TRAX™ WALL SLIDE SYSTEM



An in-wall slideout system, housing all the moving and mechanical parts within the sidewall of the motorhome.

What sets 3TRAX™ apart is the patented rail system, in-floor roller guides and electric motor design. This triple track design supports large rooms, like those found in full-wall slideouts, ensuring simple, reliable, maintenance-free operation.

F | SIDE VISION CAMERAS

Side vision cameras, integrated into the exterior mirror housing, vastly increase the line of sight along the side of the coach, helping keep you safe on the road.

LAY THE GROUNDWORK FOR SAFE TRAVELS

A home needs a strong foundation and that is especially true for the home that rolls down the road. The custom engineered structure and Freightliner chassis under the Palazzo provide an excellent base to construct your new motorhome.



A | 55° WHEEL CUT

With 55-degrees of wheel cut, turning circles can be drastically reduced. The Palazzo can turn around in even the tightest of spaces.

B | FREIGHTLINER® & MOR/RYPDE® CHASSIS

We have partnered with Freightliner Custom Chassis and Mor/Ryde manufacturing to engineer the best foundation in the business. Freightliner's advanced chassis technology provides a safe and stable platform for maneuvering the coach down the road, while Mor/Ryde's steel structure ensures the perfect integration of chassis to the home.

C | DIESEL EXHAUST FLUID

Almost all truck stops offer diesel exhaust fluid (DEF) in bulk at the pump, but only on the driver's side of the island. The Palazzo is thoughtfully designed to include the DEF tank on the driver's side of the coach.

D | 10,000-LB. HITCH

The diesel engine has plenty of torque to pull the heaviest of towed vehicles. The hitch includes a 7-pin round connector.



BACKED BY CUMMINS ONAN® POWER

You don't have to settle for second best. That's why we chose Cummins®, the number-one choice for diesel power.



The Palazzo's Cummins Onan® ISB 6.7L diesel engine is mated to a 6-Speed Allison automatic transmission, providing immense horsepower and of torque. This combination delivers maximum performance, reliability and durability.



The 6,000-watt Cummins Onan® RV diesel generator provides all the power needed to make your motorhome self-contained. Run all the appliances, air conditioners, TVs and lights without ever plugging into an electrical outlet.

Taking the extra time to ensure the best possible structure is exactly what you deserve, and this is why Thor Motor Coach insists on vacuum-bond laminating not only the sidewalls of the motorhome, but also the floor and roof. Vacuum-bonding is the optimum manufacturing process to ensure multi-layer integrity.



ROOF

- A** One-piece exterior TPO membrane
- B** Luan panels
- C** Aluminum structure with bowed framing
- D** Block foam insulation
- E** Interior panel with soft touch vinyl covering

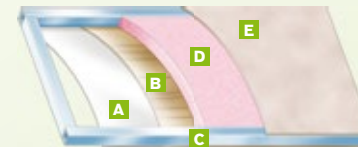

SIDEWALLS

- A** High-gloss or gel-coat fiberglass
- B** Luan panels
- C** Aluminum structure with framing at all openings
- D** Block foam insulation
- E** Interior panel with designer wall covering



FLOOR

- A** Residential vinyl flooring or carpet
- B** OSB structure wood base
- C** Structural steel framing
- D** Block foam insulation
- E** Luan with woven plastic exterior finish



36.1 | MOUNTAIN SANDS | VINTAGE MAPLE



36.2 | ENCORE | VINTAGE MAPLE



FLOOR PLANS

The Palazzo offers a wide variety of floor plans to suit your way of life. Families of all sizes will appreciate the numerous layouts available. Every inch of space, inside and out, is designed to make life on the road more livable. Organized kitchen workspaces, creative bathroom arrangements and bedroom dwellings make the most of space while remaining comfortable and functional. Every detail seems to say “welcome home”.

33.2

Chassis	Freightliner XC-S
Gross Vehicle (GVWR)	26,000
Gross Combined (GCWR)	30,000
Wheel Base	208"
Exterior Length	34'-8"
Exterior Height (w/AC)	11'-10"
Exterior Width (w/o mirrors)	101"
Interior Height (living area)	82"
Awning Size	18'
Fuel (gal)	90
LPG (lbs)	104
Fresh/Waste/Gray Water (gal)	95 / 43 / 43
Water Heater (gal)	10
Furnace (BTUs)	35,000
Exterior Storage Capacity (cu. ft.)	126

33.2

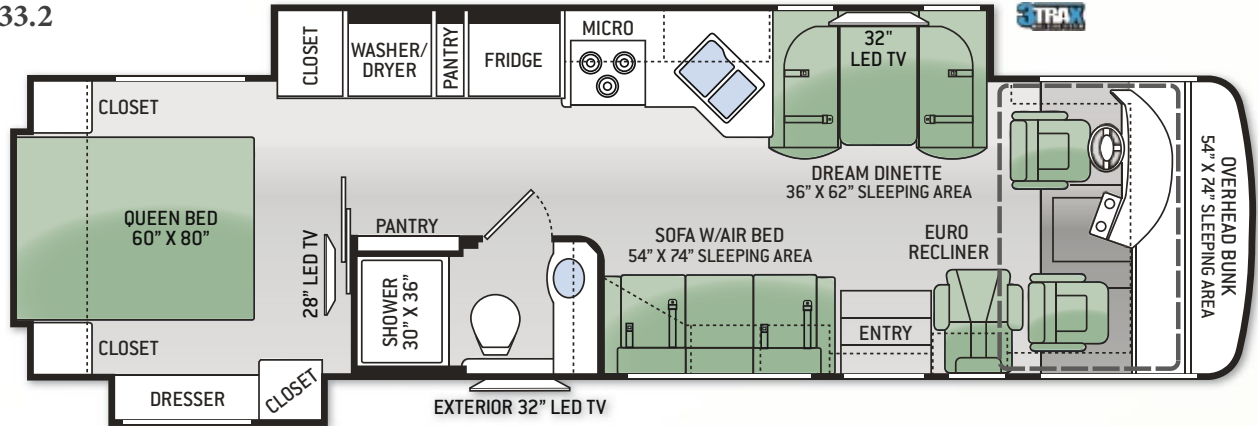

33.3

Chassis	Freightliner XC-S
Gross Vehicle (GVWR)	26,000
Gross Combined (GCWR)	30,000
Wheel Base	208"
Exterior Length	34'-8"
Exterior Height (w/AC)	11'-10"
Exterior Width (w/o mirrors)	101"
Interior Height (living area)	82"
Awning Size	18'
Fuel (gal)	90
LPG (lbs)	104
Fresh/Waste/Gray Water (gal)	95 / 43 / 43
Water Heater (gal)	10
Furnace (BTUs)	35,000
Exterior Storage Capacity (cu. ft.)	126

33.3

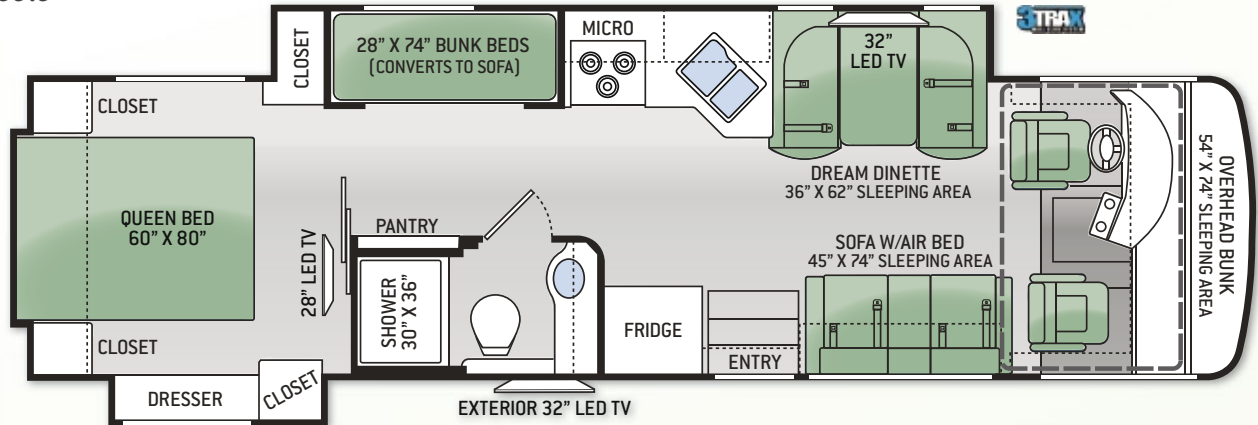

35.1

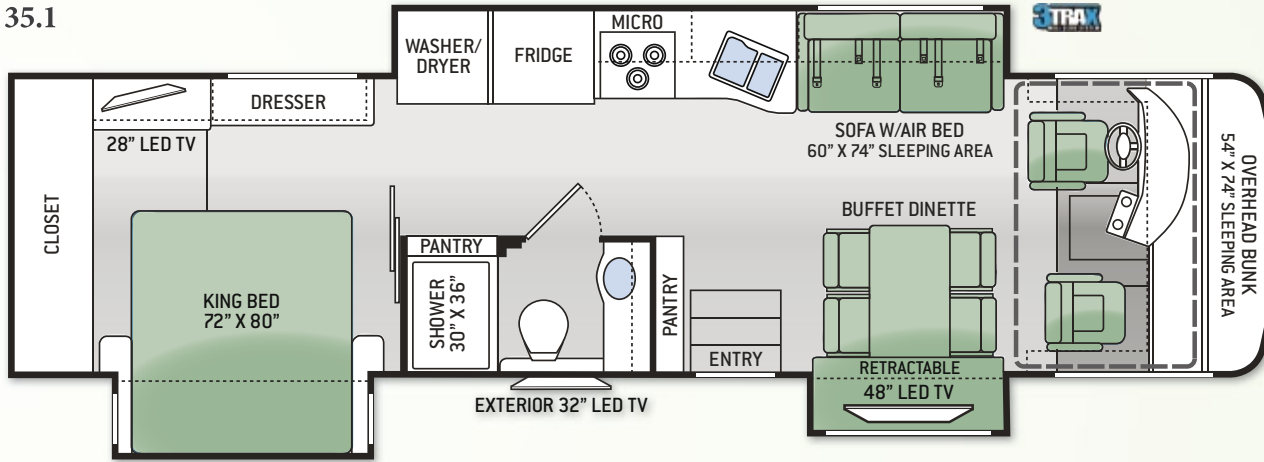

35.1

Chassis	Freightliner XC-S
Gross Vehicle (GVWR)	28,000
Gross Combined (GCWR)	33,000
Wheel Base	220"
Exterior Length	35'-8"
Exterior Height (w/AC)	12'-0"
Exterior Width (w/o mirrors)	101"
Interior Height (living area)	82"
Awning Size	17'
Fuel (gal)	90
LPG (lbs)	104
Fresh/Waste/Gray Water (gal)	95 / 43 / 43
Water Heater (gal)	10
Furnace (BTUs)	Dual 20,000
Exterior Storage Capacity (cu. ft.)	130

36.1

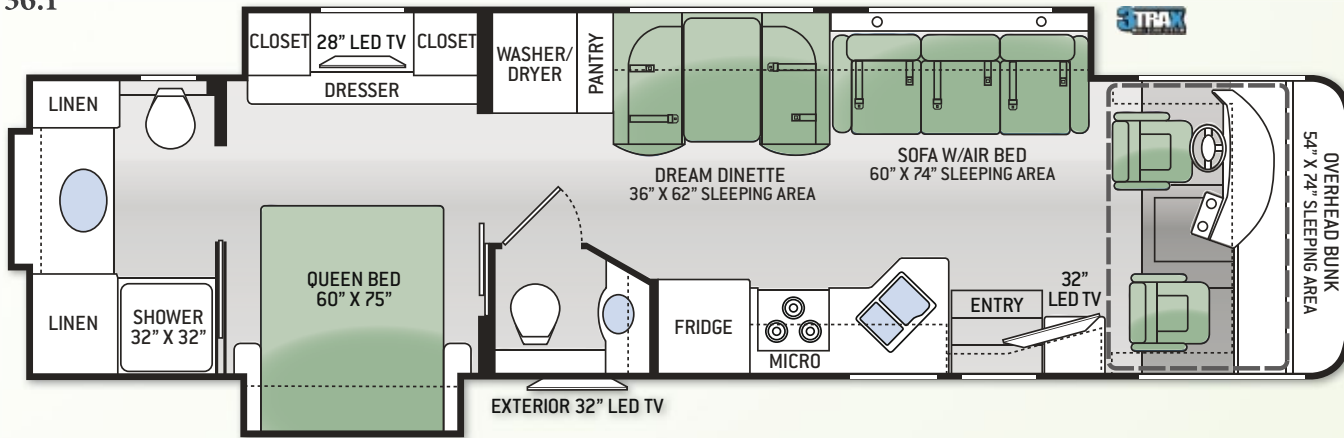

36.1

Chassis	Freightliner XC-S
Gross Vehicle (GVWR)	28,000
Gross Combined (GCWR)	33,000
Wheel Base	242"
Exterior Length	37'-6"
Exterior Height (w/AC)	12'-0"
Exterior Width (w/o mirrors)	101"
Interior Height (living area)	82"
Awning Size	17'
Fuel (gal)	90
LPG (lbs)	104
Fresh/Waste/Gray Water (gal)	95 / 60 / 43
Water Heater (gal)	10
Furnace (BTUs)	35,000
Exterior Storage Capacity (cu. ft.)	170

36.2

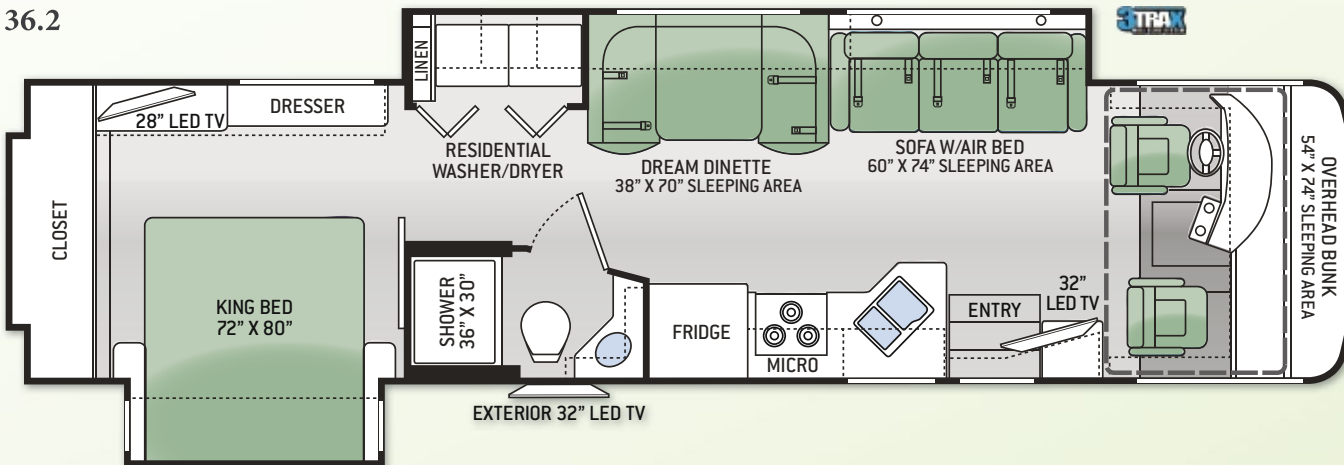

36.2

Chassis	Freightliner XC-S
Gross Vehicle (GVWR)	28,000
Gross Combined (GCWR)	33,000
Wheel Base	242"
Exterior Length	37'-6"
Exterior Height (w/AC)	12'-0"
Exterior Width (w/o mirrors)	101"
Interior Height (living area)	82"
Awning Size	17'
Fuel (gal)	90
LPG (lbs)	104
Fresh/Waste/Gray Water (gal)	95 / 43 / 43
Water Heater (gal)	10
Furnace (BTUs)	35,000
Exterior Storage Capacity (cu. ft.)	170

STANDARDS & OPTIONS

CONSTRUCTION & EXTERIOR

- Freightliner® XC-S Straight Rail Chassis
- Cummins® ISB 6.7L Diesel Engine with 300HP, 660 lb.-ft. Torque (33.2 & 33.3)
- Cummins® ISB 6.7L Diesel Engine with 340HP, 700 lb.-ft. Torque (35.1, 36.1 & 36.2)
- 6-Speed Allison Automatic Transmission
- Air-Ride Suspension
- Full Air Front & Rear Drum Anti-Lock Brakes
- Dual Fuel Fills
- One-Piece Fiberglass Front & Rear Caps
- Invisible Bra
- One-Piece Windshield
- Full-Body Paint Package with Gel-Coat Sidewalls
- Automatic Leveling Jacks with Touchpad Controls
- Full Basement Pass-Through Storage Compartment
- Easy Slide Storage Tray (33.2, 33.3, 36.1 & 36.2)
- Side-Hinged, Flush Mount Radius Luggage Doors
- Power Patio Awning with Integrated LED Lighting
- Slideout Topper Awnings
- 3TRAX™ Wall Slide System 
- Frameless Dual Pane Windows
- Roof Ladder
- Automatic Electric Entry Step
- Entry Door with Deadbolt Lock
- Outside Shower

AUTOMOTIVE & COCKPIT

- Touchscreen Dash Radio with CD Player & Back-Up Monitor
- Heated/Remote Exterior Mirrors with Integrated Side View Cameras
- Leatherette Reclining/Swivel Captain's Chairs with 6-Way Power Adjustment Driver's Seat
- Fog Lights

Thor Motor Coach is the industry leader in innovative design and builds a variety of unique styles, sizes and floor plans that feel custom-made – at a truly competitive price.

IMPORTANT - PLEASE READ: This brochure reflects product design, fabrication, material, components and specifications at the date of printing, which date is disclosed on the last page. PLEASE VISIT US ONLINE AT THORMOTORCOACH.COM OR CONSULT WITH YOUR SELLING DEALERSHIP FOR THE LATEST IN STANDARDS, OPTIONS, SPECIFICATION AND TECHNICAL INFORMATION. Photographs in the brochure may depict optional equipment or may only be available in certain floor plans. Components, appliances and the chassis may have been manufactured in a calendar year before the vehicle's designated model year. All capacities are approximate. The actual length of the vehicle may differ from that indicated in the brochure due to variances in the manufacturing processes and/or installed components. All dry weights are based on standard model features and do not include optional features or equipment. Component part and appliance manufacturers issue limited warranties covering portions of the vehicle not covered under the limited warranty we issue.

Copyright Thor Motor Coach, Inc. © 12/15/14

- Power Front Roller Shade with Accordion-Style Side Window Shades
- LED Ceiling Mounted Dome Light with Dash Switch
- 10,000-lb. Trailer Hitch with 7-pin Round Connector
- 22.5" Tires with Stainless Steel Wheel Liners
- Valve Stem Extenders on Rear Tires
- Dash Workstation with 110-volt & 12-volt Outlets

INTERIOR

- Residential Vinyl Flooring Throughout
- Hardwood Raised Panel Cabinet Doors with Nickel Finish Hardware
- LED Ceiling Lights
- Soft Touch Vinyl Ceiling
- Window Solar & Privacy Shades in Living Area
- Leatherette Euro Recliner with Integrated Ottoman (33.2)
- Leatherette Sofa with Air Bed
- Dream Dinette™ Booth (33.2, 33.3, 36.1 & 36.2)
- Free Standing Buffet Dinette with Four (4) Chairs (35.1)
- Power Drop-Down Hide-Away Overhead Bunk

KITCHEN

- Residential Refrigerator
- 3-Burner Gas Cooktop
- 30" Over-the-Range Convection Microwave Oven
- Solid Surface Countertops
- Large Double Bowl Sink with Single Handle Kitchen Faucet
- 12-volt Attic Fan

BEDROOM & BATHROOM

- Denver Mattress® King Size Bed (35.1 & 36.2)
- Denver Mattress® Queen Size Bed (33.2, 33.3 & 36.1)
- Bedspread with Throw Pillows
- Attractive Headboard
- Sconce Wall Lighting (33.2 & 33.3)

- Porcelain Toilet
- Oversized Shower with Glass Door
- Power Vent in Bathroom

ENTERTAINMENT

- Mid-Ship Entertainment Center with 48" LED TV, DVD Player & Sound Bar (35.1)
- Mid-Ship Entertainment Center with 32" LED TV, DVD Player & Sound Bar (33.2, 33.3, 36.1 & 36.2)
- 28" LED TV in Bedroom
- 13" & 22" LED TVs in Bunk Beds (33.3)
- Exterior 32" LED TV
- Cable TV Ready

ELECTRICAL & PLUMBING

- Cummins Onan® RV QD 6000 Diesel Generator
- Automatic Generator Start
- 50-amp Service with Shoreline Power Cord
- Dual 13,500 BTU Ducted Low-Profile Roof Air Conditioners
- Dual 20,000 BTU Ducted Electronic Ignition Furnaces (35.1)
- 35,000 BTU Ducted Electronic Ignition Furnace (33.2, 33.3, 36.1 & 36.2)
- Four (4) Auxiliary House Batteries
- Battery Disconnect Switch
- 10-gallon DSI Gas/Electric Water Heater
- Water Heater Bypass System
- Black Water Tank Flush
- Stackable Washer/Dryer (33.2, 35.1 & 36.1)
- Side-by-Side Washer & Dryer (36.2)
- Systems Control Center



Made to fit.

P.O. Box 1486, Elkhart, IN 46515
Sales Department: 800.860.5658
Customer Service: 877.855.2867



PalazzoRV.com

YOUR LOCAL THOR MOTOR COACH DEALER

